

FRONT VIEW

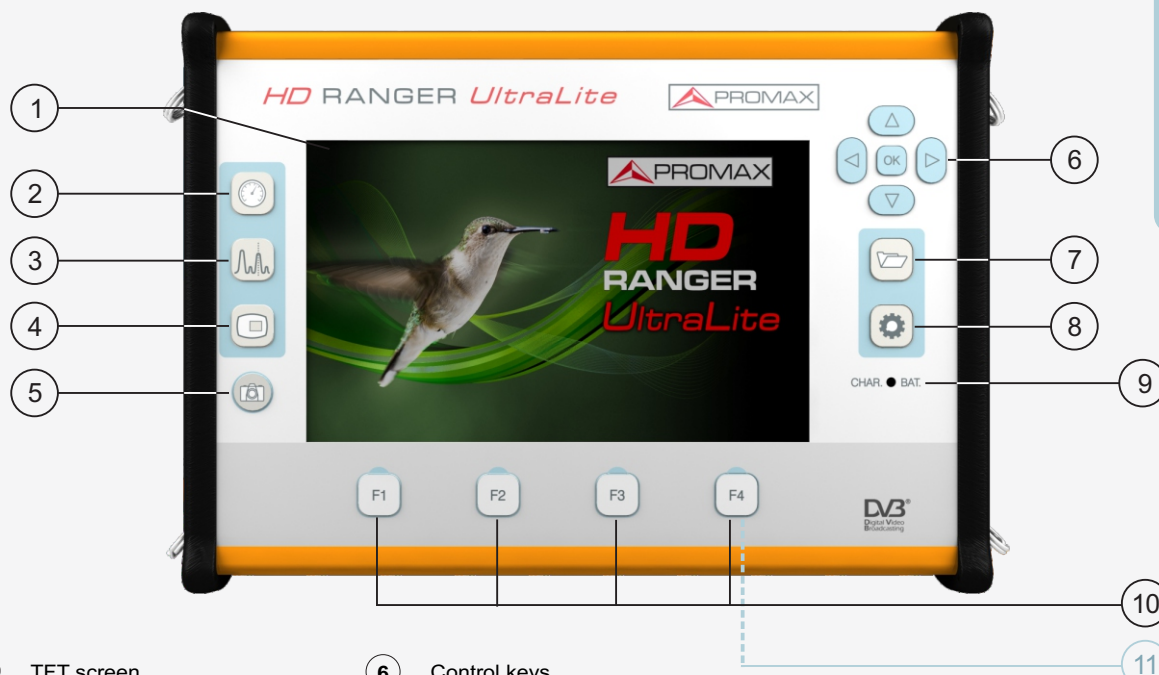

- | | |
|---|--------------------------------|
| ① TFT screen | ⑥ Control keys |
| ② Measurement key | ⑦ Installations management key |
| ③ Spectrum key | ⑧ Settings key |
| ④ TV Key | ⑨ Battery charging indicator |
| ⑤ Export (press>1s)
Reference (press<1s) | ⑩ Softkeys |
| | ⑪ Reset (press and hold 5s) |

SCREEN ICONS REFERENCE

STATUS BAR

- Battery charging**
- Battery not charging.** Yellow level indicates charge left
- USB** in serial port mode
- Satellite band**
- Current voltage, 22 kHz signal and LNB power level
- Terrestrial band**
- USB flash drive** inserted
- Current installation**
- Compressed installation**
- SatCR** (SCD/EN50494) commands enabled
- JESS** (SCD2/EN50607) commands enabled
- Task scheduled
- Control keys** multi-function enabled
Two-letter code indicates the exact function:
 - FR** Frequency tuning
 - CH** Channel tuning
 - SP** SPAN change
 - MK** Marker moving
 - EC** Echo change/zoom

SERVICE LIST SELECTOR

- Digital TV service** **High Definition TV service**
- Digital radio** **Data** **Scrambled service**

DIALOG BOXES

- Error message** **OK message**
- Question message** **Warning message**

VIDEO & AUDIO SETTINGS MENU

- TFT backlight brightness** **Volume**

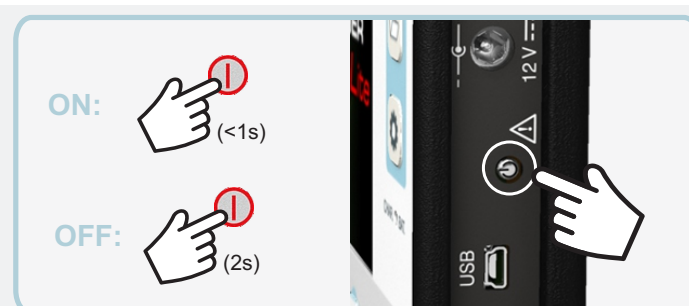

MEASUREMENT

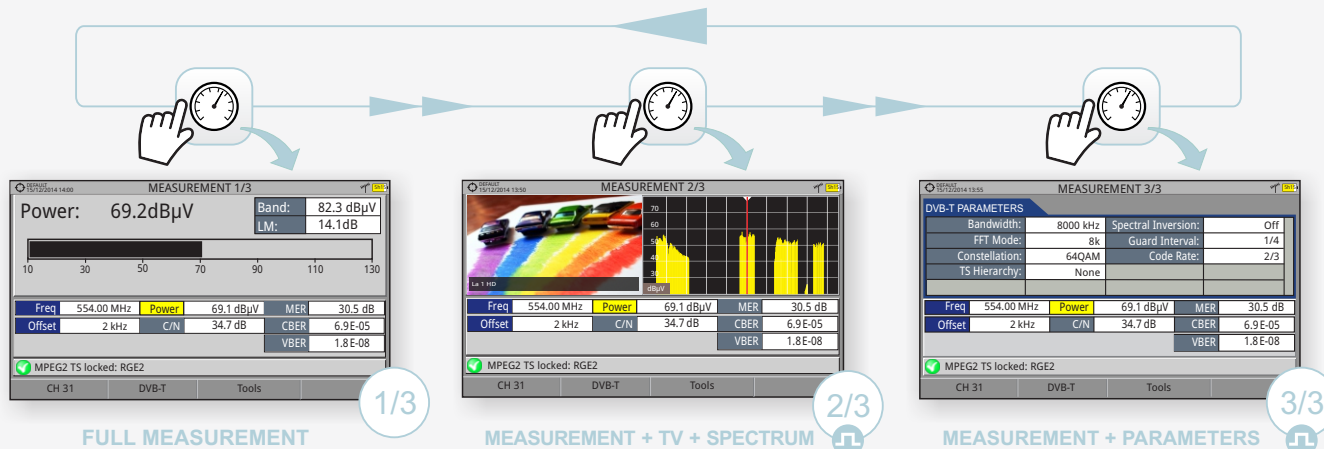

SPECTRUM ANALYSER

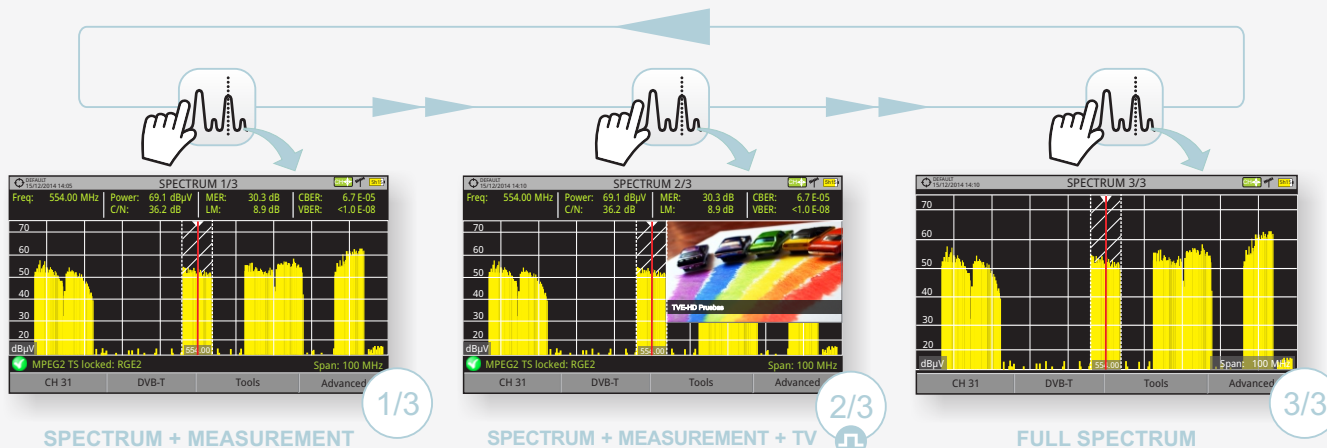

TV MODE

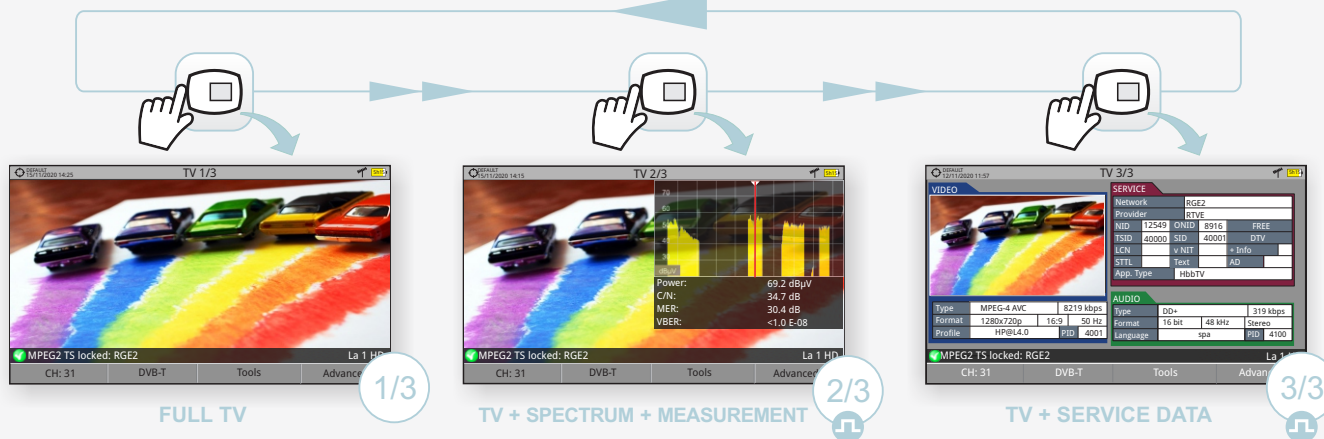

CONTROL KEYS

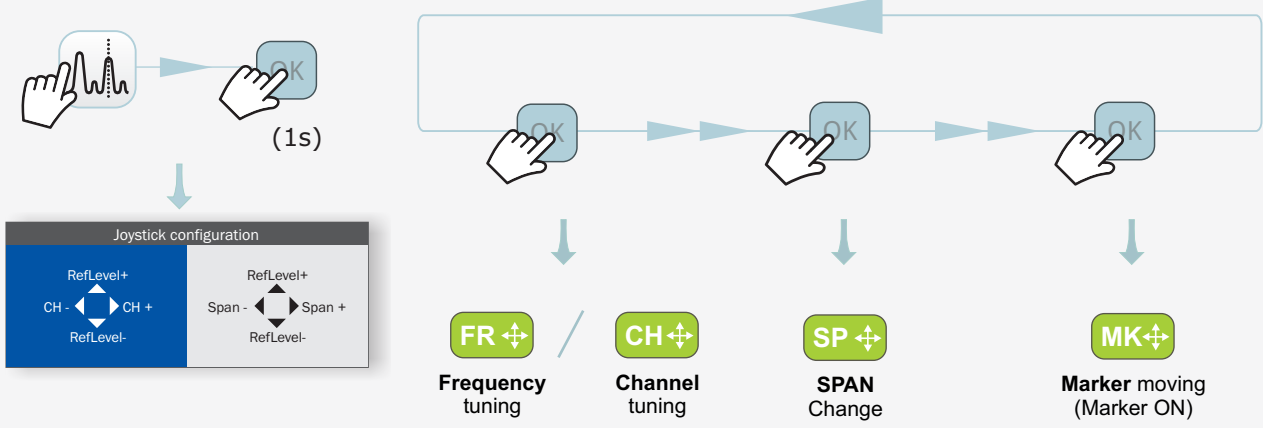

EXPORT*

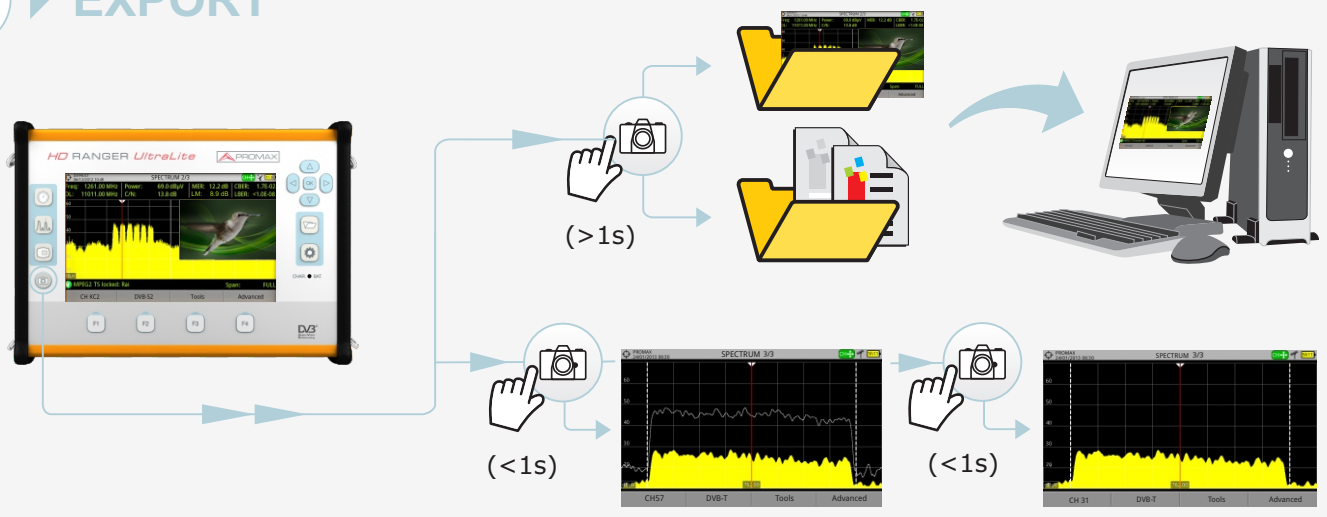

*Export settings in Preferences

INSTALLATIONS MANAGEMENT

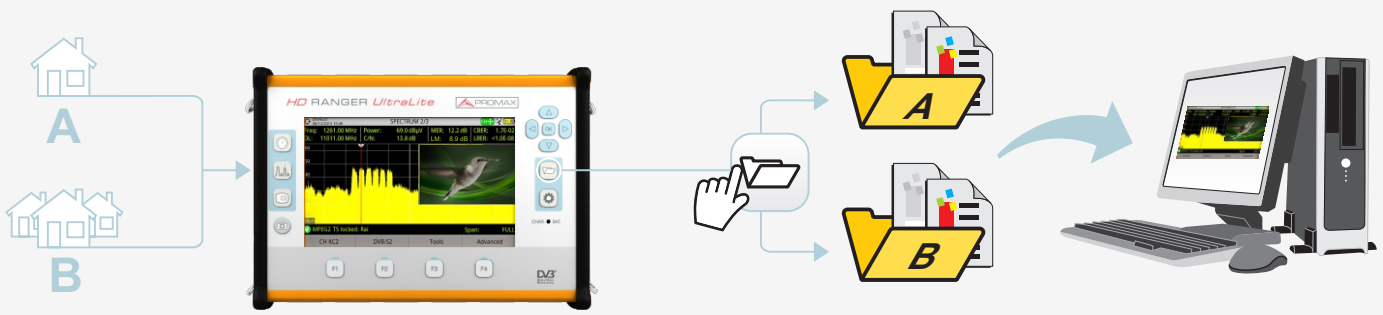

SPECTRUM ANALYSER MENU

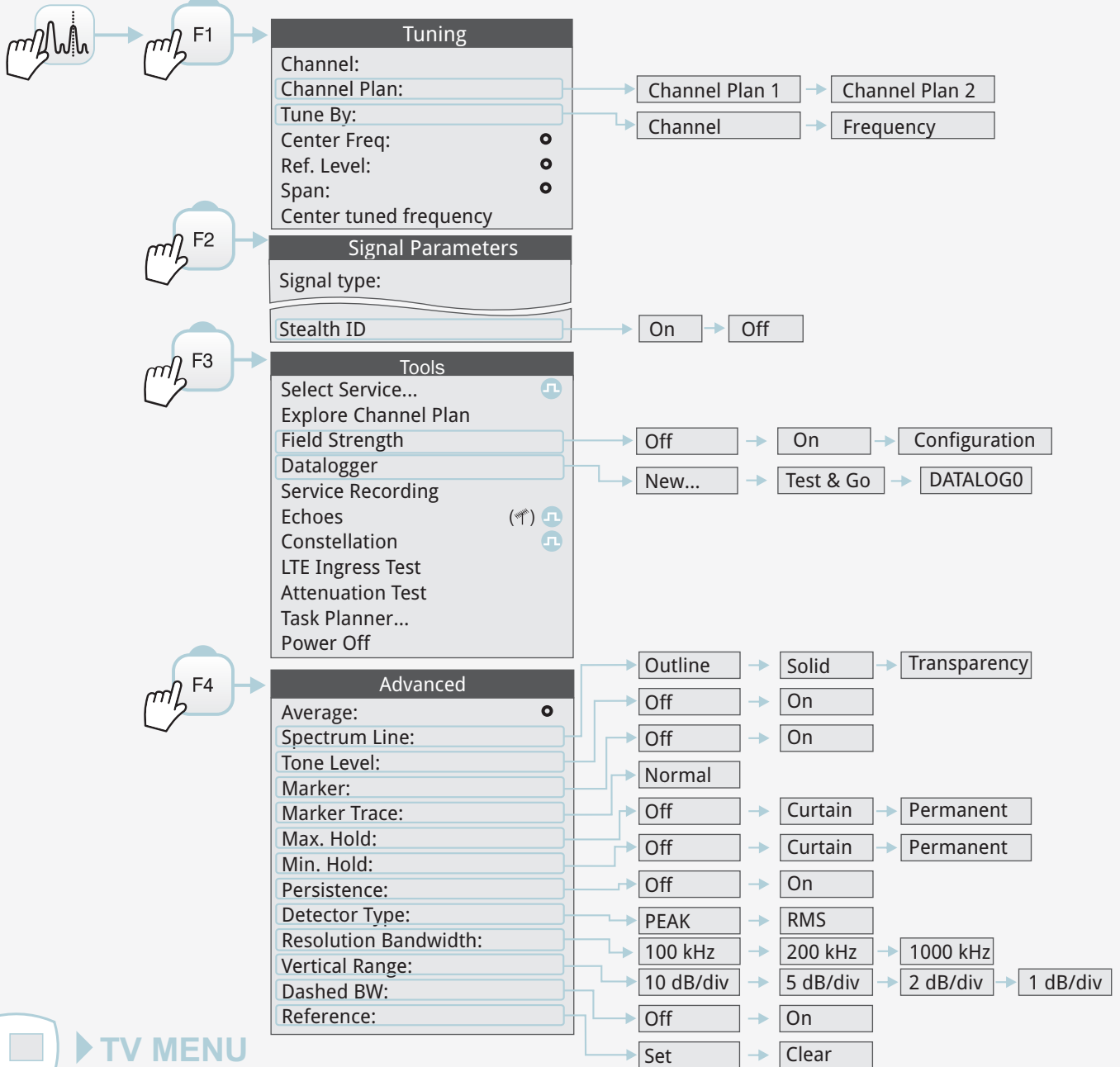

TV MENU

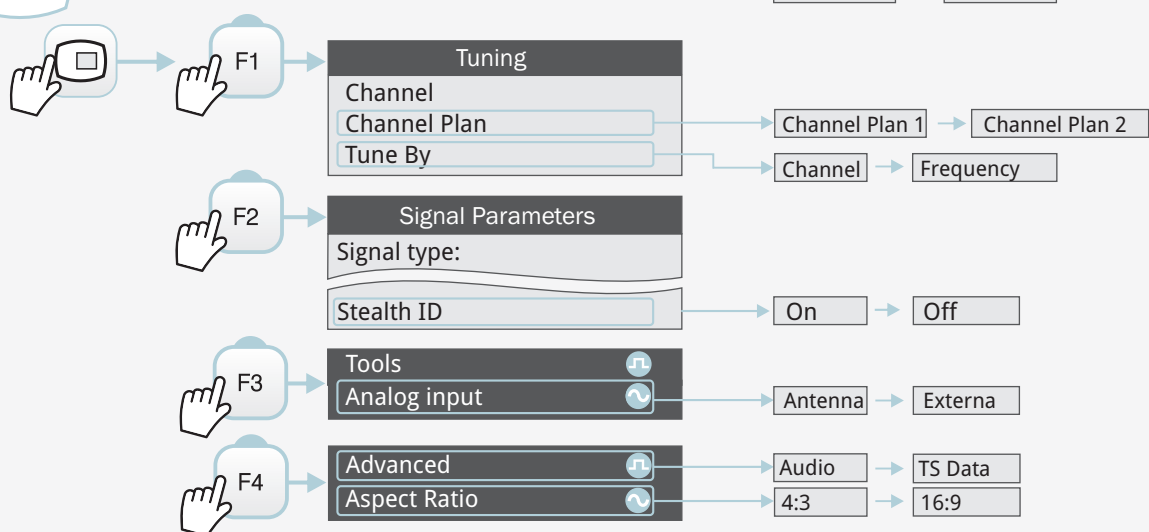



UP

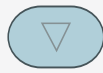

DOWN



LEFT



RIGHT



VALIDATE

PARAMETER EDITION

The diagram illustrates the process of editing the Center Freq parameter in the Tuning menu through six sequential steps:

- Step 1:** Press the **F1** function key to enter the Tuning menu. The menu shows: Channel: 44, Channel Plan: CCIR, Tune By: Channel, Center Freq: 658.00 MHz.
- Step 2:** Press the **DOWN** arrow key three times (x3) to highlight the Center Freq field.
- Step 3:** Press the **VALIDATE** icon to activate the cursor in the Center Freq field.
- Step 4:** Press the **LEFT** arrow key to move the cursor to the right of the decimal point.
- Step 5:** Press the **UP** arrow key to increment the value from 658.00 to 658.10.
- Step 6:** Press the **VALIDATE** icon to confirm the change. The final Center Freq is 658.10 MHz.

PARAMETER SELECTION

The diagram illustrates the process of selecting the Spectrum Line parameter in the Advanced menu through five sequential steps:

- Step 1:** Press the **F4** function key to enter the Advanced menu. The menu shows: Average: 0, Spectrum Line: Outline, Tone Level: Off.
- Step 2:** Press the **DOWN** arrow key to highlight the Spectrum Line field.
- Step 3:** Press the **VALIDATE** icon to activate the cursor in the Spectrum Line field.
- Step 4:** Press the **DOWN** arrow key to open the selection list, which includes Outline, Solid, and Trans.
- Step 5:** Press the **VALIDATE** icon to confirm the selection. The final Spectrum Line setting is Solid.

INSTALLATIONS MANAGEMENT

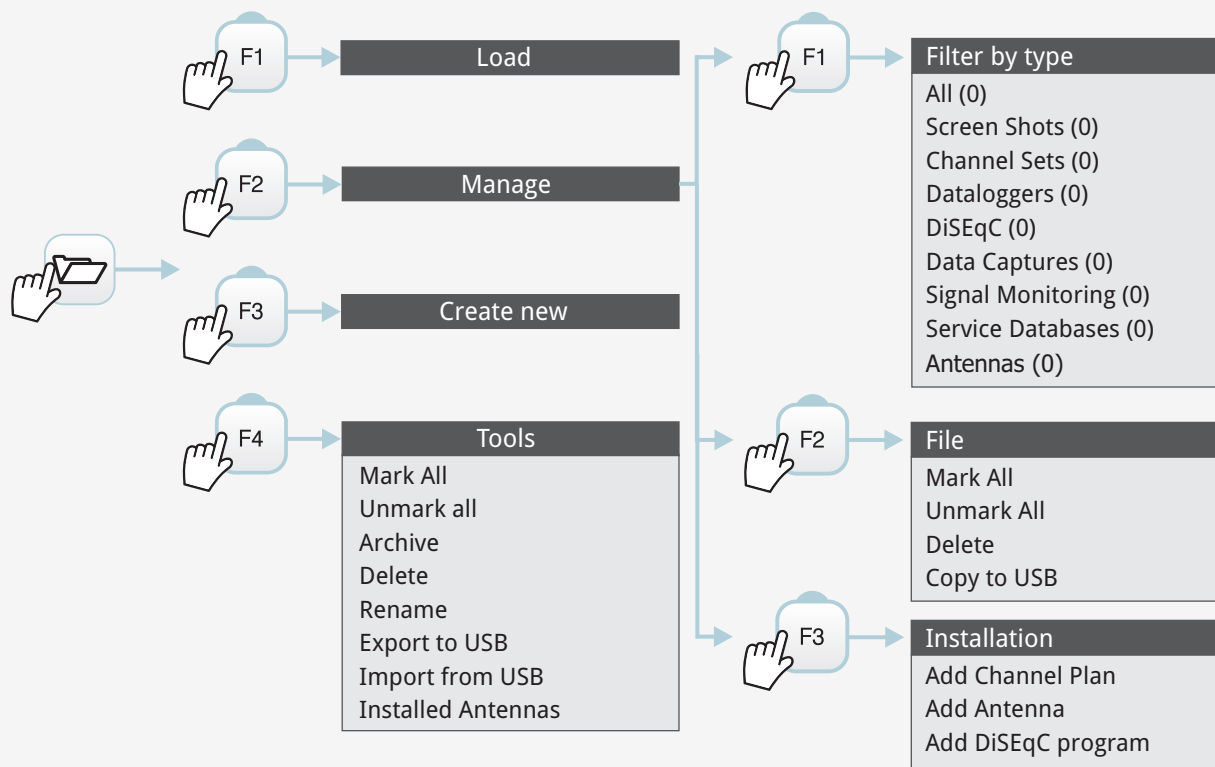

PREFERENCES MENU

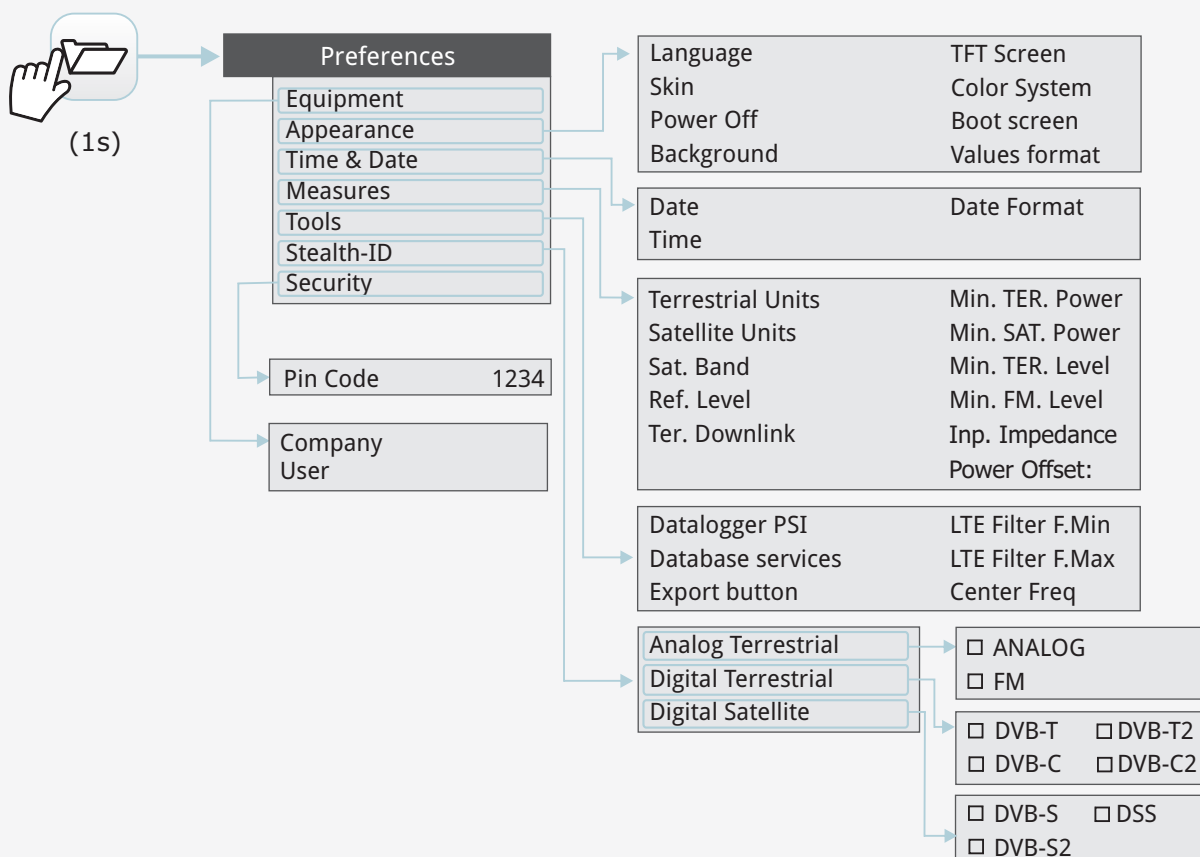



SETTINGS MENU

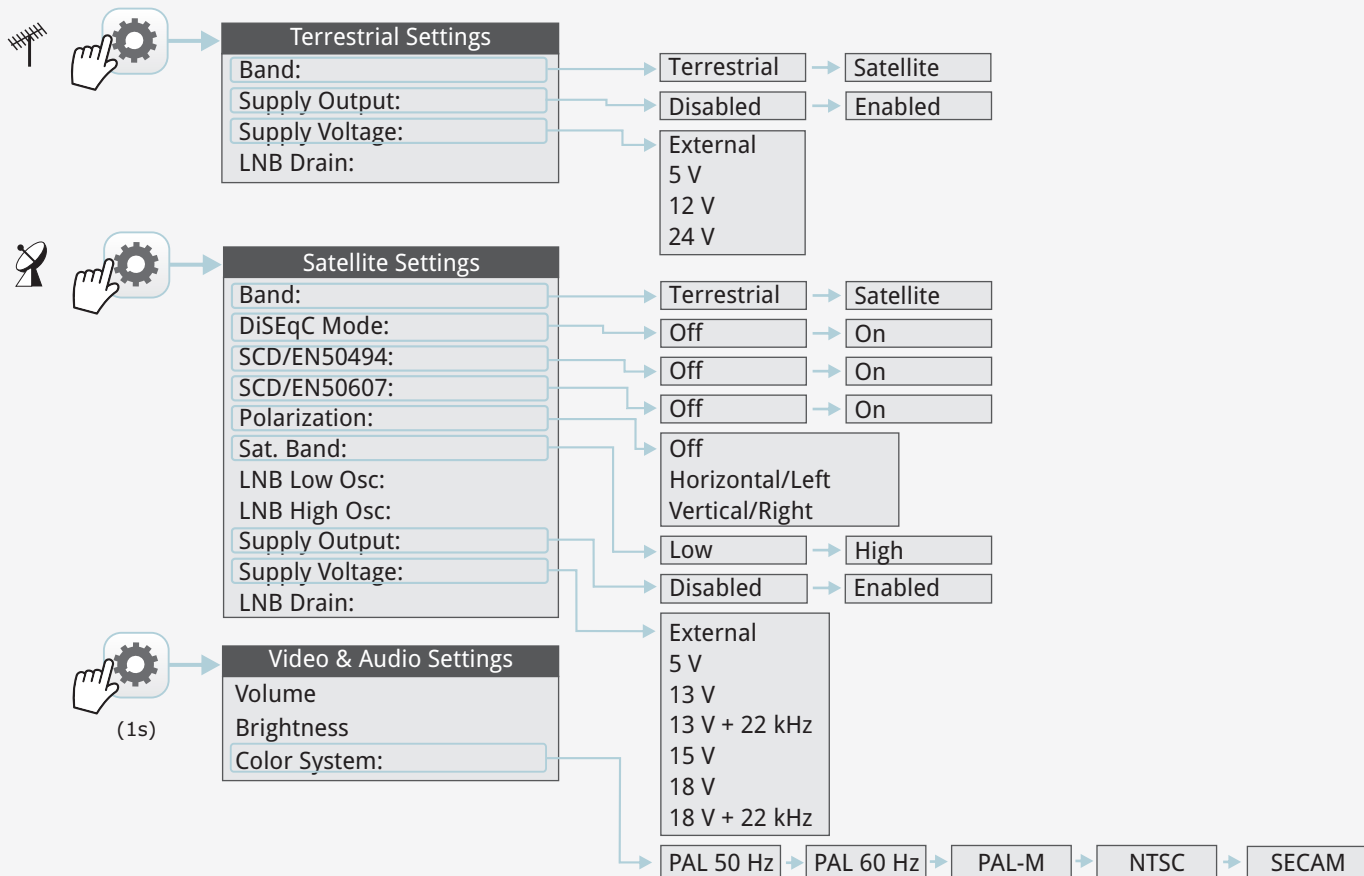

MEASUREMENT MENU

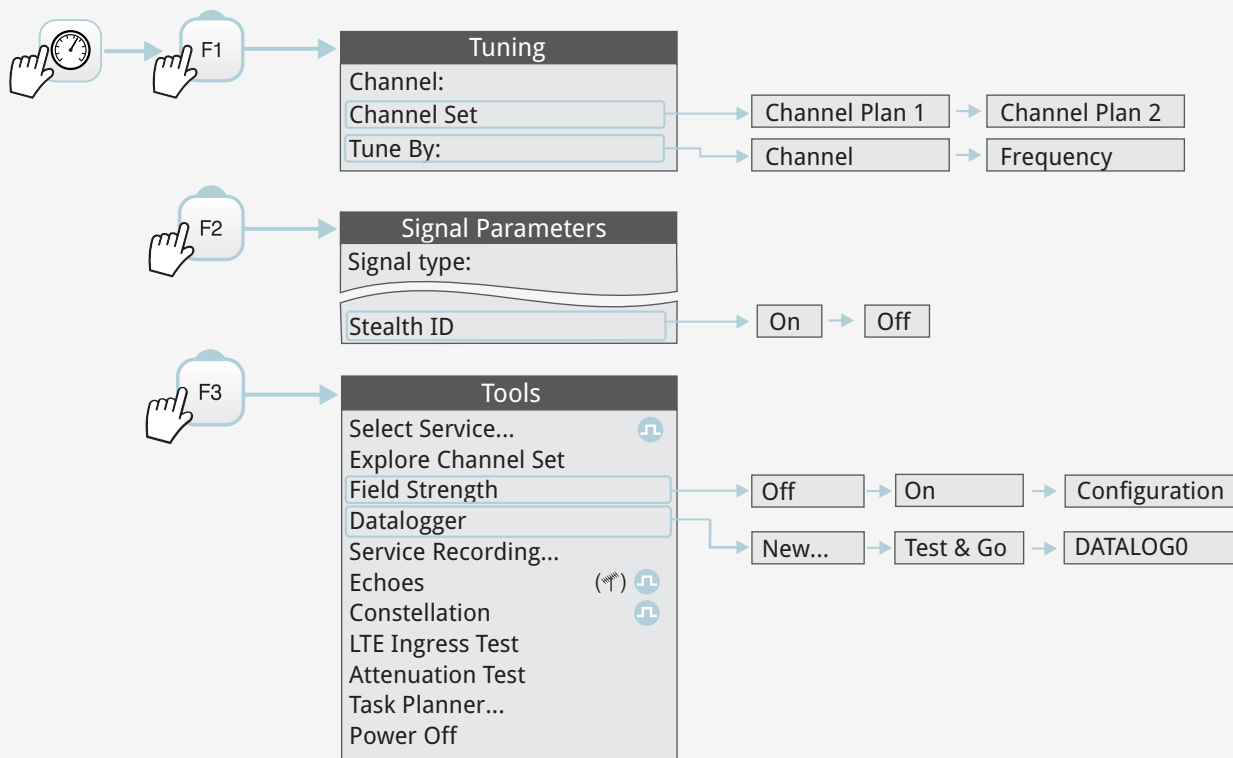

LEFT SIDE VIEW

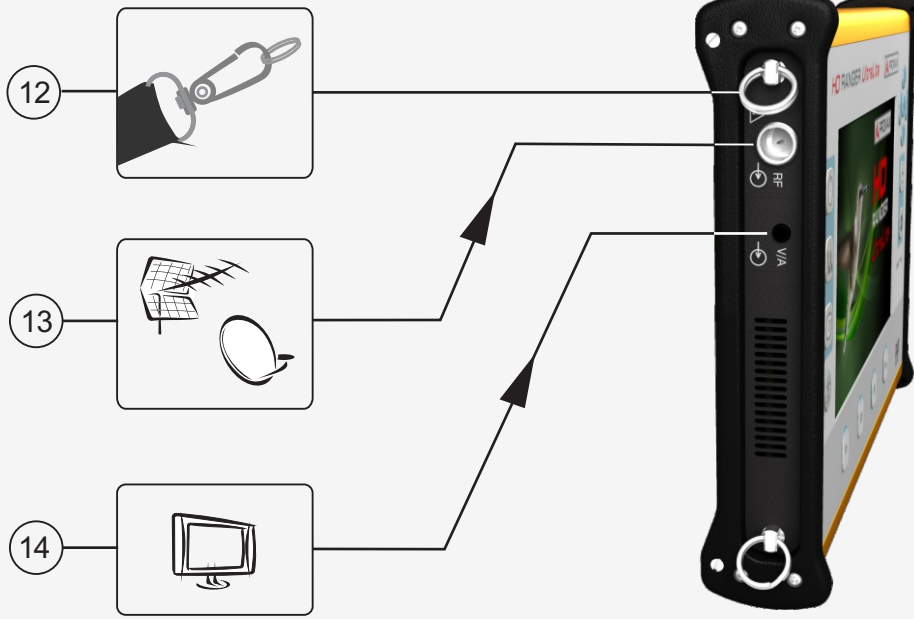

12 Keyring for transport belt

13 RF input connector

14 Video/Audio input

RIGHT SIDE VIEW

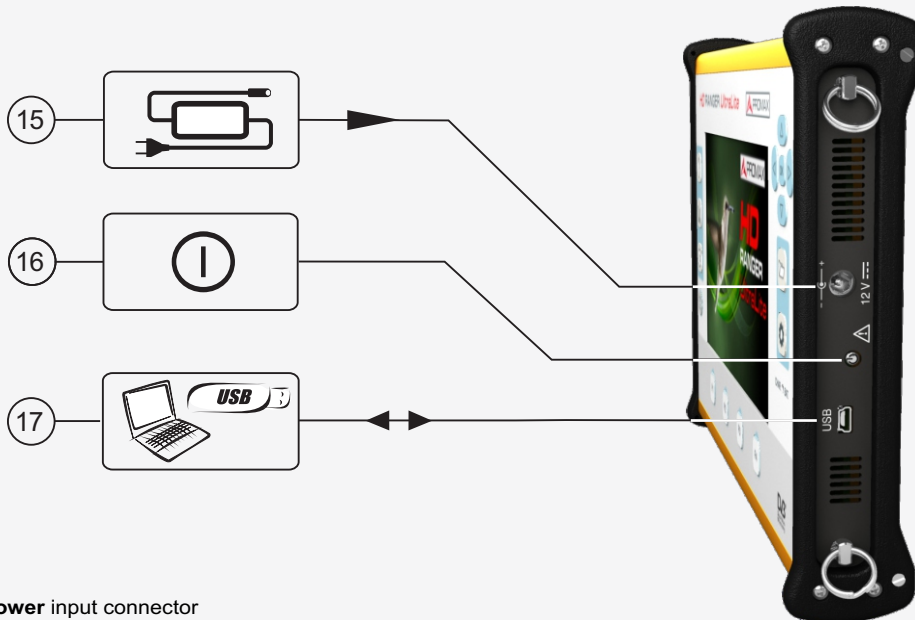

15 Power input connector

16 ON/OFF button

17 Mini-USB connector

