

FRONT VIEW



Trademark of the DVB - Digital Video Broadcasting Project



- | | | |
|---|--------------------------------|------------------------------|
| 1 TFT screen | 6 Joystick | 11 Reset (press and hold 5s) |
| 2 Measurement key | 7 Installations management key | |
| 3 Spectrum key | 8 Settings key | |
| 4 TV Key | 9 Battery charging indicator | |
| 5 Export (press>1s)
Reference (press<1s) | 10 Softkeys | |

SCREEN ICONS REFERENCE

STATUS BAR

- Battery charging**
- Battery not charging.** Yellow level indicates charge left
- USB in serial port mode**
- Satellite band**
- Current voltage, 22 kHz signal and LNB power level**
- Terrestrial band**
- USB flash drive inserted**
- Current installation**
- Compressed installation**
- SatCR** (SCD/EN50494) commands enabled
- JESS** (SCD2/EN50607) commands enabled
- Task scheduled**
- Joystick multi-function enabled**
Two-letter code indicates the exact function:
 - FR** Frequency tuning
 - CH** Channel tuning
 - SP** SPAN change
 - MK** Marker moving
 - EC** Echo change/zoom

SERVICE LIST SELECTOR

- Digital TV service** **High Definition TV service**
- Digital radio** **Data** **Scrambled service**

DIALOG BOXES

- Error message** **OK message**
- Question message** **Warning message**

VIDEO & AUDIO SETTINGS MENU

- TFT backlight brightness** **Volume**

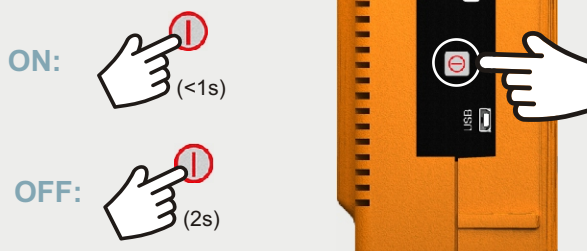



MEASUREMENT

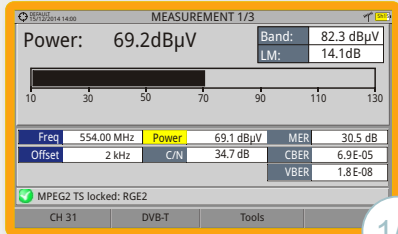

FULL MEASUREMENT

1/3

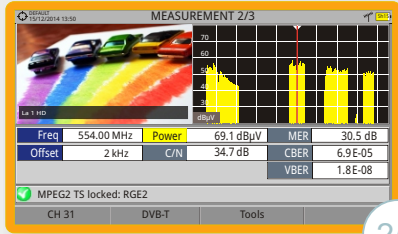

MEASUREMENT + TV + SPECTRUM

2/3

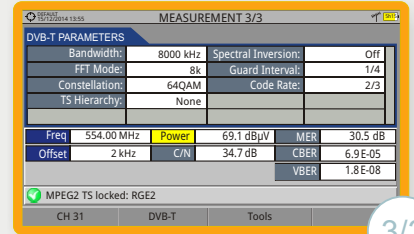

MEASUREMENT + PARAMETERS

3/3



SPECTRUM ANALYSER

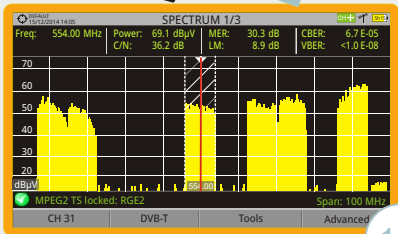

SPECTRUM + MEASUREMENT

1/3

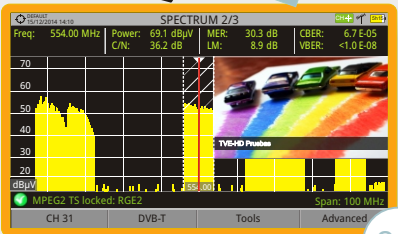

SPECTRUM + MEASUREMENT + TV

2/3

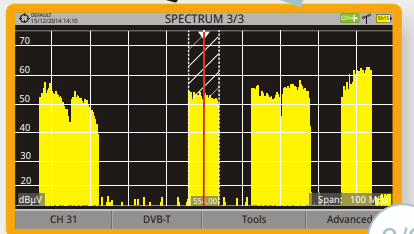

FULL SPECTRUM

3/3



TV MODE

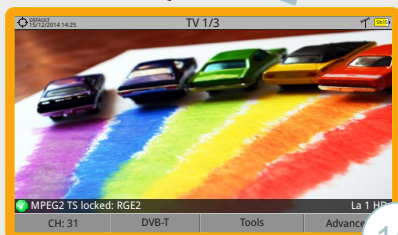
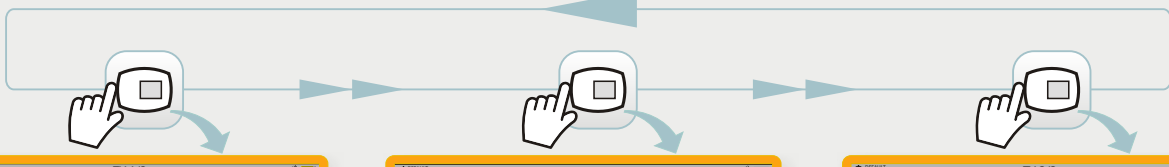

FULL TV

1/3

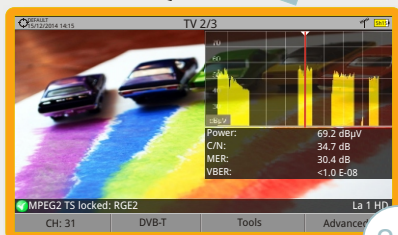

TV + SPECTRUM + MEASUREMENT

2/3

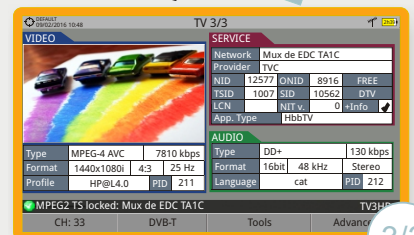

TV + SERVICE DATA

3/3

▶ JOYSTICK

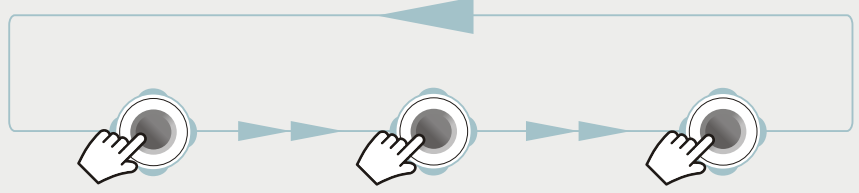
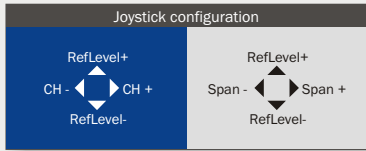
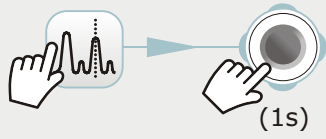

FR ↕
Frequency tuning

CH ↕
Channel tuning

SP ↕
SPAN Change

MK ↕
Marker moving (Marker ON)

▶ EXPORT*

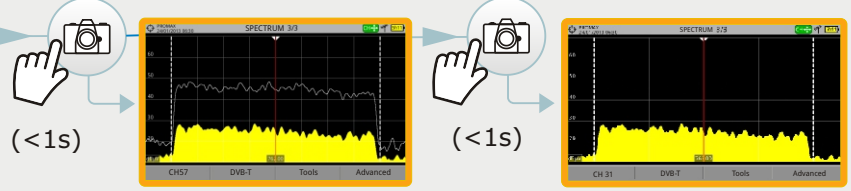
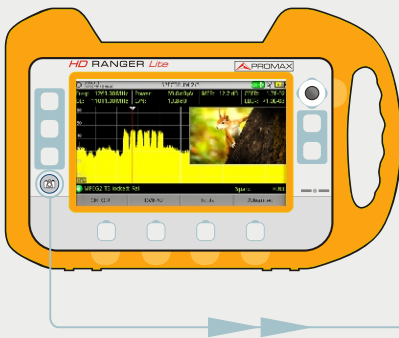

*Export settings in Preferences

▶ INSTALLATIONS MANAGEMENT

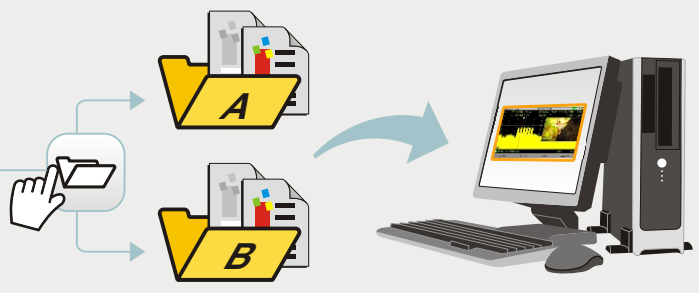

SPECTRUM ANALYSER MENU

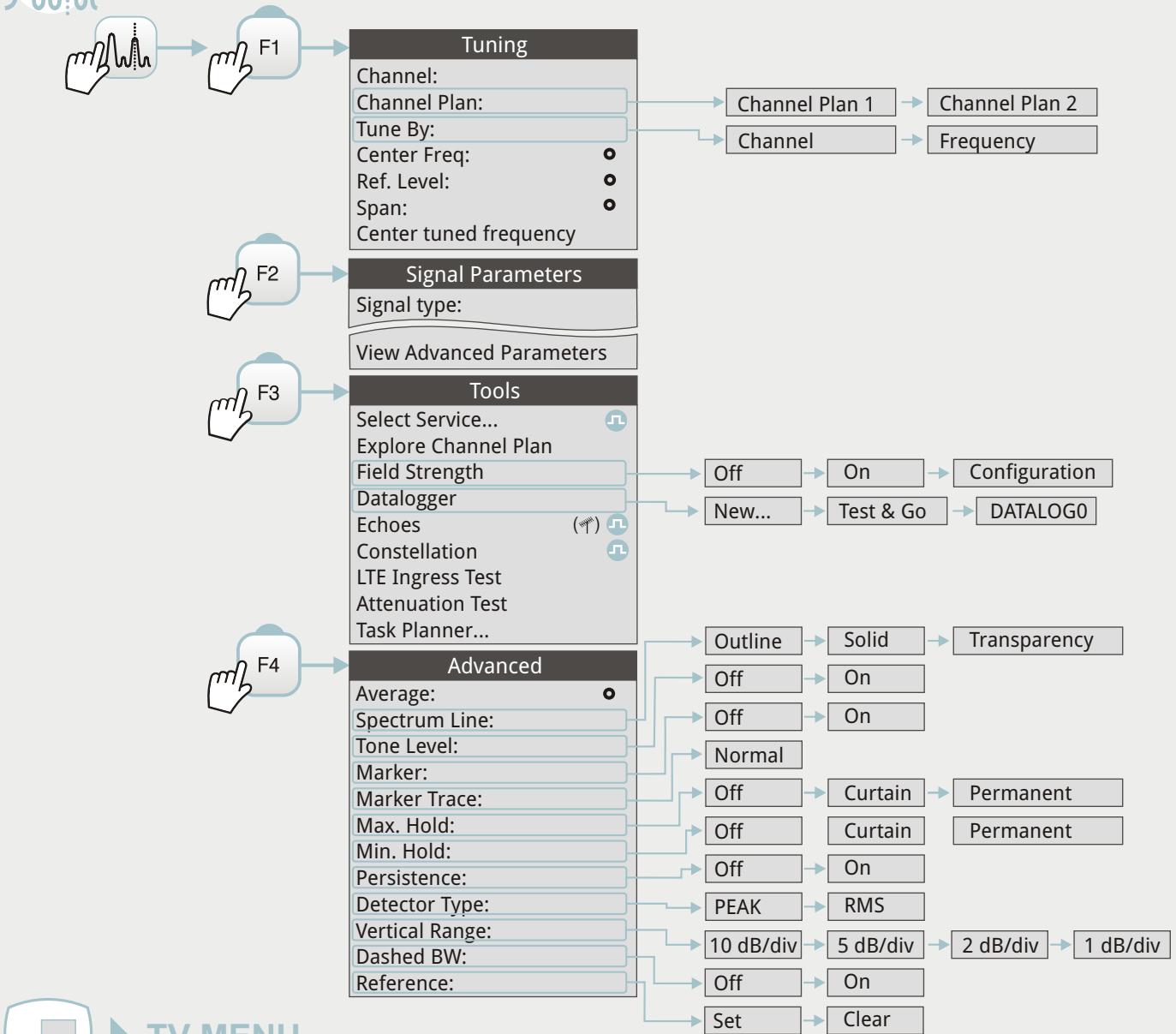

TV MENU

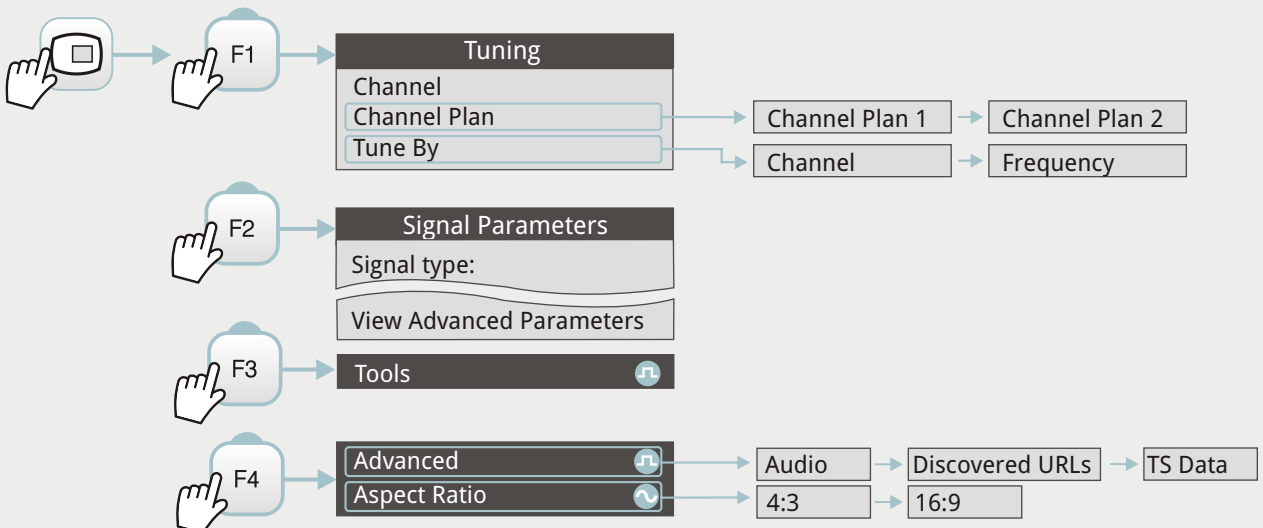

📶 Option available for **terrestrial band**

📡 Option available for **satellite band**

📶 Only available for **digital channels**

📶 Only available for **analog channels**



UP



DOWN



LEFT



RIGHT



VALIDATE

PARAMETER EDITION

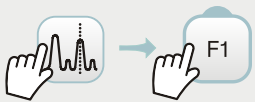

Tuning	
Channel:	44
Channel Plan	CCIR ▶
Tune By:	Channel ▶
Center Freq:	658.00 MHz ●



x3

Tuning	
Channel:	44
Channel Plan	CCIR ▶
Tune By:	Channel ▶
Center Freq:	658.00 MHz ●

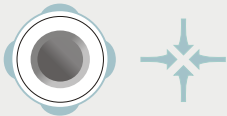

Tuning	
Channel:	44
Channel Plan	CCIR ▶
Tune By:	Channel ▶
Center Freq:	658.00 MHz ●



Tuning	
Channel:	44
Channel Plan	CCIR ▶
Tune By:	Channel ▶
Center Freq:	658.00 MHz ●



Tuning	
Channel:	44
Channel Plan	CCIR ▶
Tune By:	Channel ▶
Center Freq:	658.10 MHz ●

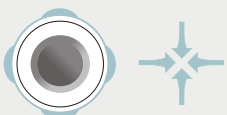

Tuning	
Channel:	44
Channel Plan	CCIR ▶
Tune By:	Channel ▶
Center Freq:	658.10 MHz ●

PARAMETER SELECTION



Advanced	
Average	0 ●
Spectrum Line	Outline ◄
Tone Level	Off ▶



Advanced	
Average	0 ●
Spectrum Line	Outline ◄
Tone Level	Off ▶

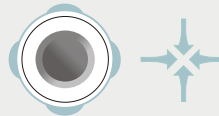

Advanced	
Average	0 ●
Spectrum Line	Outline ◄
Tone Level	Off ▶

- Outline
- Solid
- Trans.



Advanced	
Average	0 ●
Spectrum Line	Outline ◄
Tone Level	Off ▶

- Outline
- Solid
- Trans.

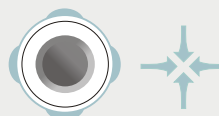

Advanced	
Average	0 ●
Spectrum Line	Solid ◄
Tone Level	Off ▶

INSTALLATIONS MANAGEMENT

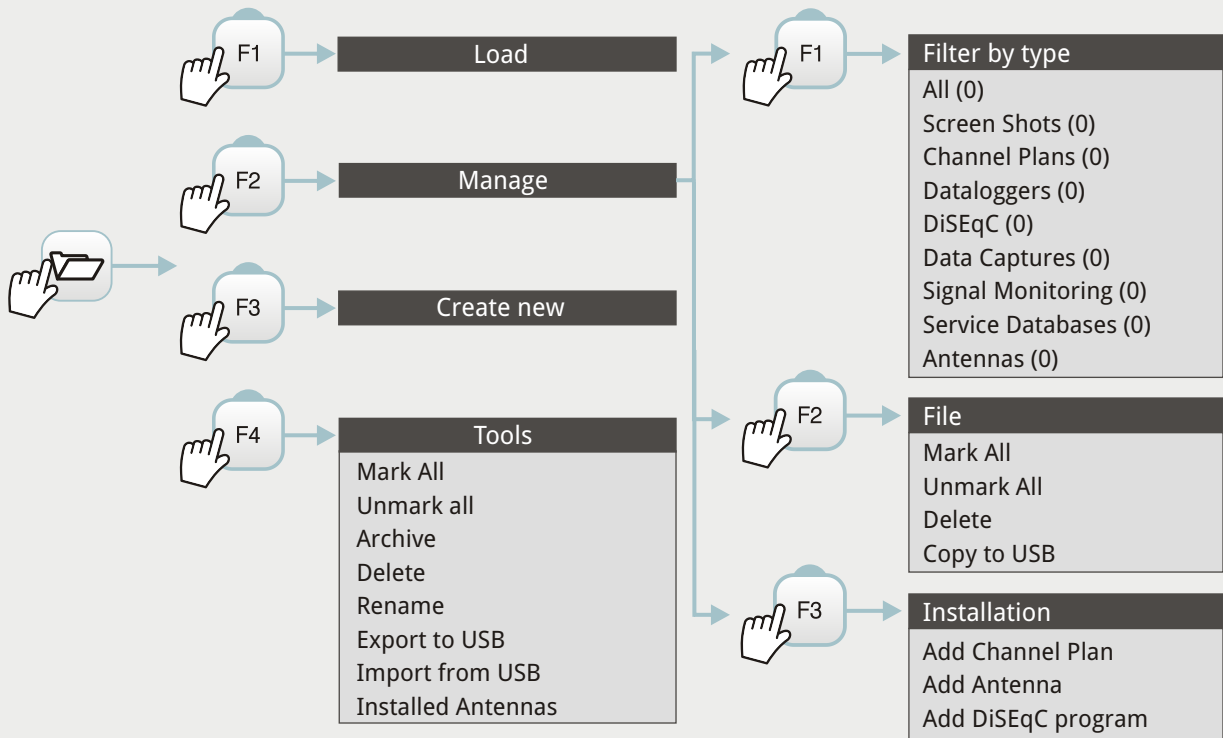

PREFERENCES MENU

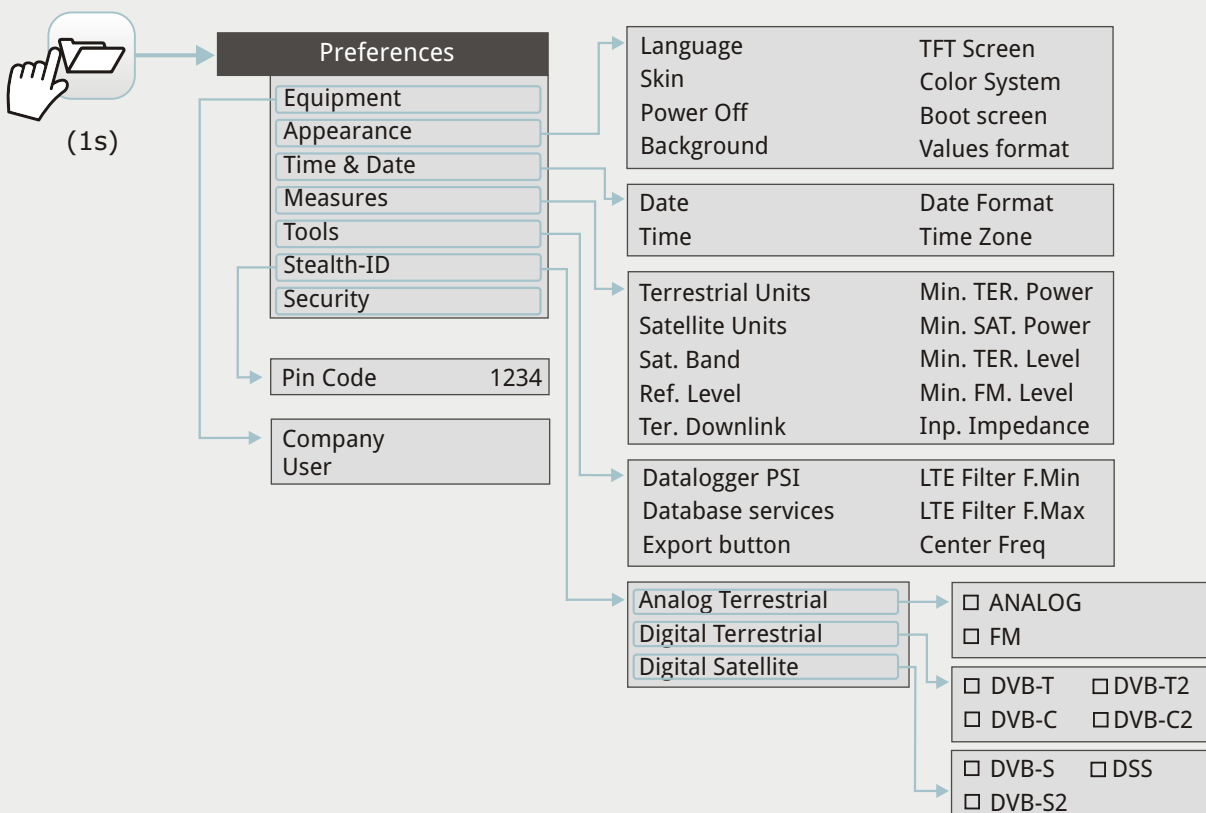

SETTINGS MENU

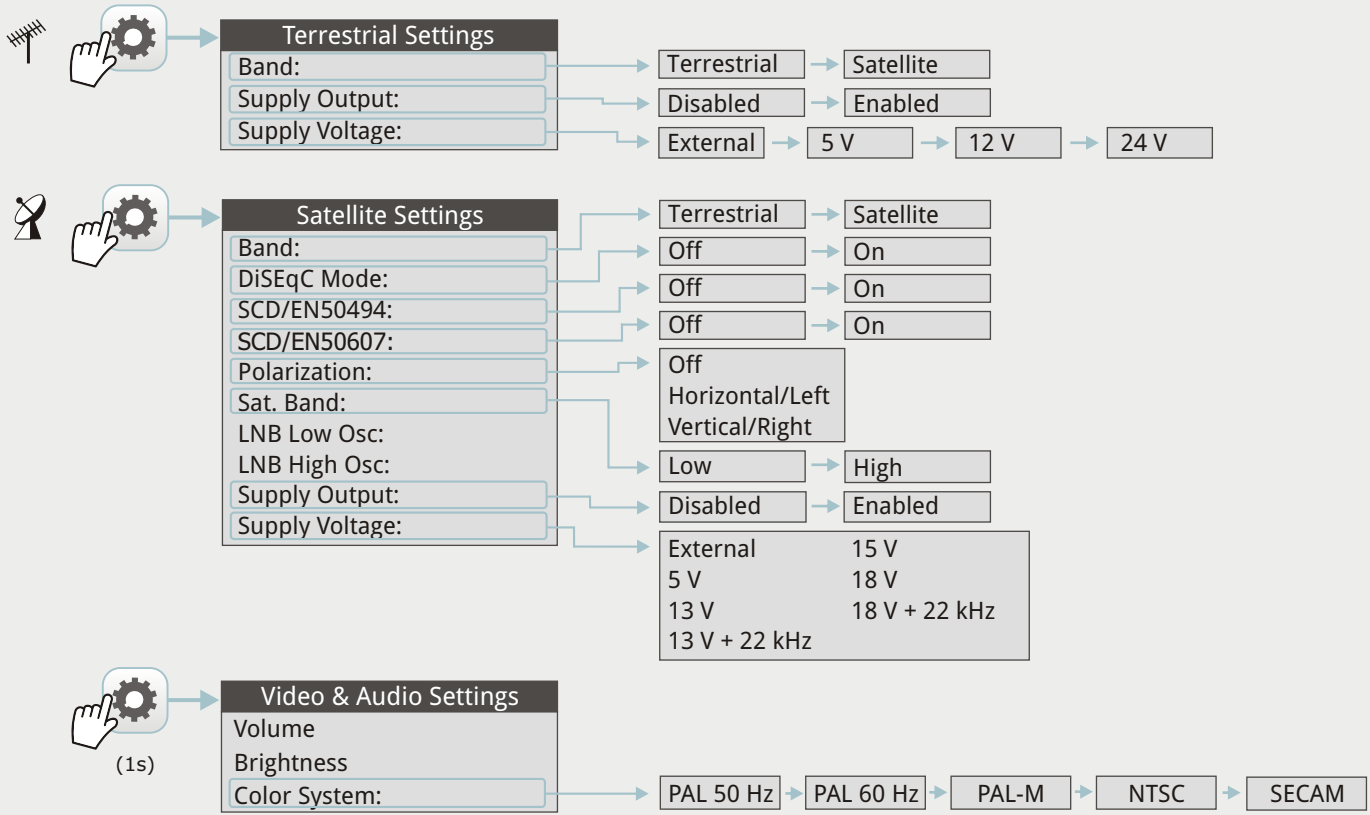

MEASUREMENT MENU

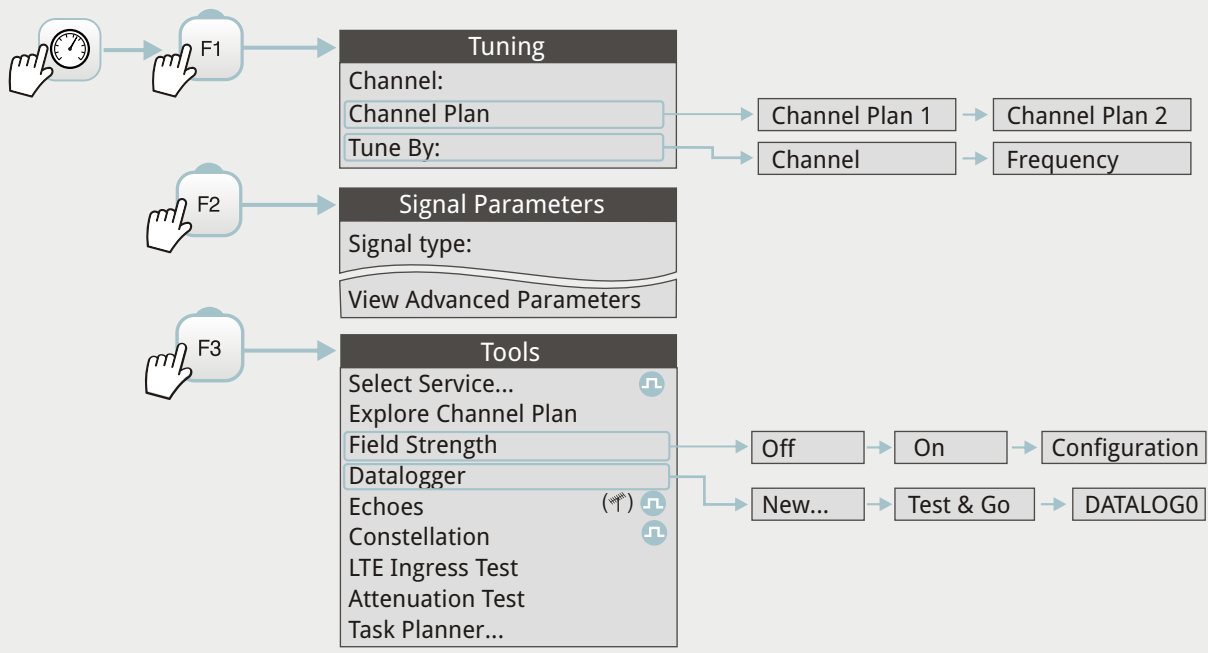

Option available for **terrestrial band**

Option available for **satellite band**

Only available for **digital channels**

TOP VIEW

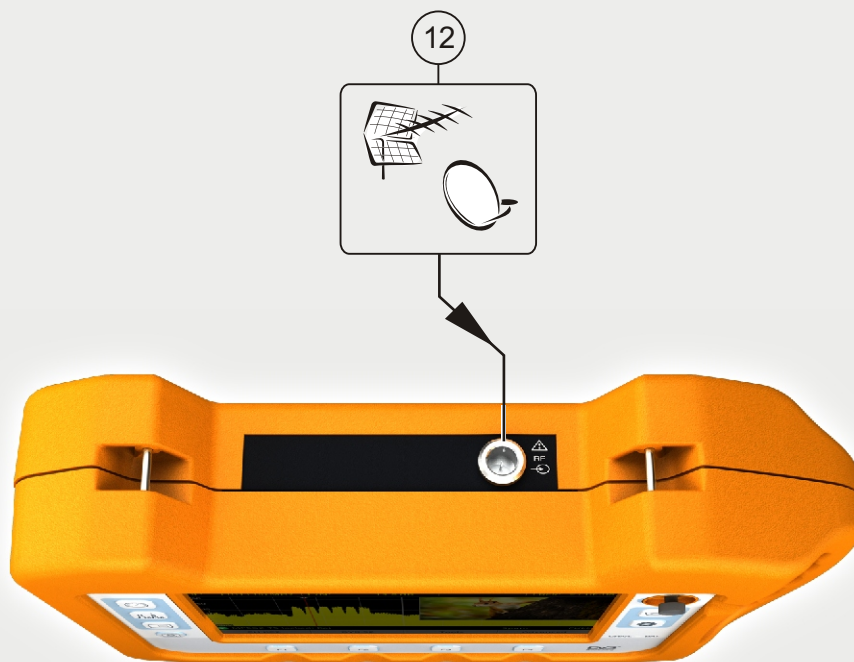

12 RF input connector

SIDE VIEW

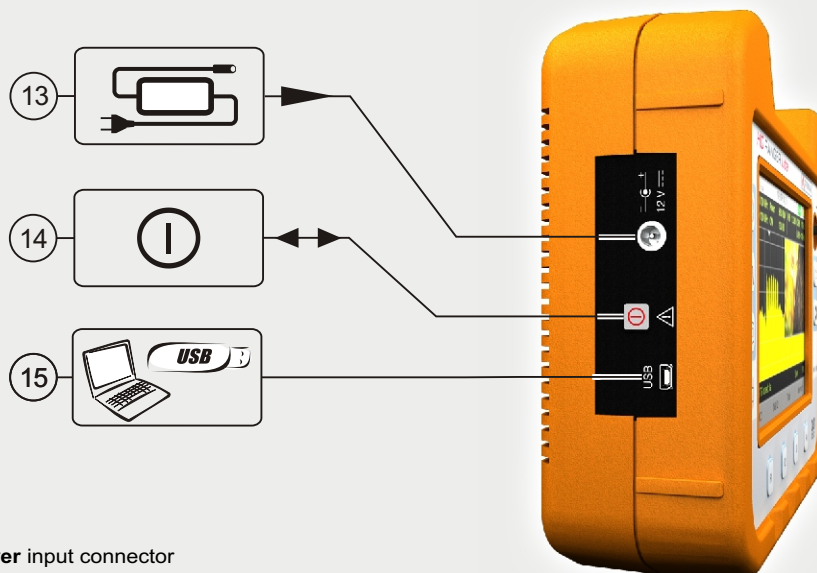

- 13 Power input connector
- 14 ON/OFF button
- 15 Mini-USB connector

